



Major Surgery Light

APEX

Your choice for no-drift positioning and exceptional performance.

The Right Light

PHILIPS
burton

Major Surgery Light

APEX

Reliable operation, simplicity and ease of use are the hallmarks of every Philips Burton product, and the new APEX is no exception.

For optimum illumination (120,000 lux / 11,148 fc at 1 meter), the highest quality no-drift arm system, reliability and true color rendering, there is no better value than Burton's APEX. Plus, an efficient multi-bulb design eliminates the need for complicated back-up bulb systems used in single source lights.



Features

- High-intensity of 120,000 lux (11,148 fc) at 1 meter
- 4200 K color temperature offers pure white illumination (without blue hues)
- High CRI (Color Rendering Index) of 95
- 24" (61 cm) diameter lighthead
- Unlimited arm rotation on single ceiling mount units
- Focuses with center autoclavable handle for exceptionally smooth focus
- Control box, including on/off switch and continuous intensity adjustment, for 120V / 100V models. For 230V / 240V models, box not included.
- Durable, aesthetic arm system that is recognized for drift-free, trouble-free operation
- 120V model standard, 100V and 230 / 240V models available
- 5-year limited warranty
- Assembled in USA

APEX Range of Motion

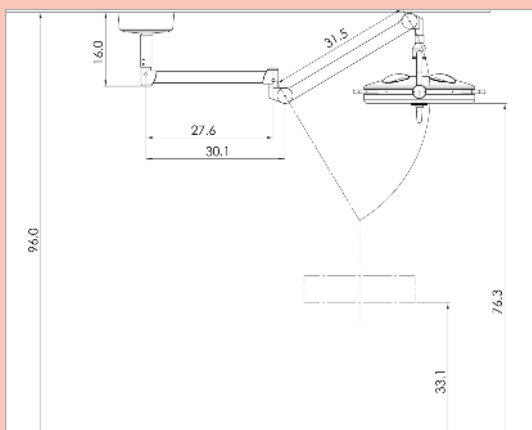

APEX 8-FT.

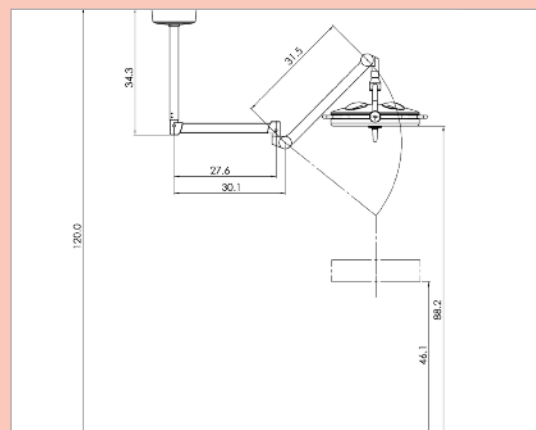

APEX 10-FT.



Ordering Information

120V Model	230/240V Model	120V SP Model*	230/240V SP Model*	100V Model	Description
APXSC8	APXSC825	APXSC8SP	APXSC825SP	APXSC80I	8' Single Ceiling Mount
APXSC10	APXSC1025	APXSC10SP	APXSC1025SP	APXSC100I	10' Single Ceiling Mount
APXDC8	APXDC825	APXDC8SP	APXDC825SP	APXDC80I	8' Double Ceiling Mount
APXDC10	APXDC1025	APXDC10SP	APXDC1025SP	APXDC100I	10' Double Ceiling Mount
Accessories					
0002004PK					APEX Replacement Bulbs, 6/Box
0008100PK					Light Handle Covers, Sterile, 25/Box

*SP Model refers to Spanish Language Manuals.

Summary of technical data

Illuminance:	120,000 lux (11,148 fc) at 1 meter
Color temperature:	4200 K
CRI (Color Rendering Index):	95
Diameter of lighthead:	24" (61 cm)
Light field:	8" - 10" (20 cm - 25 cm)
Depth of field without refocusing:	17" (43 cm)
Focusing:	Adjustable using center handle
Dimming:	Continuous dimming (not discrete) from control panel
Number of bulbs:	4
Light sources (halogen):	50W, 24V; wired in parallel for continuous light output
Rated life of halogen lamp:	1400 hours
Head movement:	Unlimited (continuous) rotation +/- 70° tilt for single ceiling mount units
Sterilizable handle:	Sterilizable handle locks into position with one hand
Irradiance emission:	Significantly below IEC recommended limit of < 1000W/m2 at highest intensity
Heat on lighthead cover:	Unique internal heat shields ensure that heat is significantly low
Swivel radius of lamp housing-ceiling mounted:	54" (137 cm) to center of lamp head
Height adjustment of lamp housing-ceiling mounted:	30" (80 cm)
Recommended ceiling height:	10' (305 cm)
Control box 100V and 120V:	Wall-mounted control box measures 6" x 5" x 2-1/2" (l x h x d) and includes on/off switch
Power:	237 Watts
Mounting options:	Single Ceiling, Double Ceiling
Total weight:	Single: 121 lbs. (55 kg); double: 226 lbs. (102 kg)
Seismic calculations available:	Yes
Battery option/emergency electrical power:	Yes
Bulb change mechanism:	Tool-less entry from reverse of lighthead
Applications:	Operating Room, Emergency Room, Trauma Center, Surgery Center, LDR, Cath Lab, Outpatient Surgery, Plastic Surgery, Ophthalmology & Surgery Suites
Certifications/approvals :	UL60601-1 / IEC 60601-1 / IEC 60601-1-2 / IEC 60601-2-41 CAN/CSA C22.2 601-1 M90 CE marked
Product warranty:	5-years parts and labor
Origin:	Assembled in USA

Note: The optical data are nominal values based on measurements calculated according to UL/IEC performance standards at 120V



Philips Burton
21100 Lassen Street Chatsworth, CA 91311
Phone: 818-701-8700 Fax: 818-701-8725
www.burtonmedical.com

© 2011 Philips Burton. All rights reserved. Product designs protected by copyright.
We reserve the right to change details of design, materials and finishes.

LIT-0054, Rev. 2