

Examination Light

# Super Exam LED

A combination of flexible drift-free positioning, excellent light output and LED energy-saving technology.



**PHILIPS**  
**burton**

Examination Light

# Super Exam LED

User-friendly and exceptional performance.

Delivering superior illumination to a focused area, Philips Burton's Super Exam LED light is ideal for general examination.

## Usability

- Flexible and precise covered spring-balanced arm is easy to position exactly where light is required
- The power and dimming switch is positioned near the handle for one-handed operation
- Easy access handle designed for quick positioning

## Performance

- High performing energy efficient LED components are virtually maintenance free
- Recessed LED light source to reduce glare
- Fully dimmable for the perfect amount of light
- Industry leading 5-year warranty
- Night light, low light output mode to prevent disturbing patients

## Construction

- SteriTouch® coating inhibits the growth of bacteria
- Powder-coated metal construction for durability
- Light source covered with tempered glass
- Smooth surface design for easy wipe down with hospital-grade disinfectants

### Floor and Table



### Horizontal Movement

(left): Designed for maximum movement in the horizontal plane. Typical applications: Floorstand, table mounted.

### Vertical Movement

(right): More vertical movement than arms found on large examination lights. The arm will always tilt forward to avoid collisions with the wall. Typical applications: Wall mounted, ceiling mounted.

### Wall and Ceiling





*Drift-free K-arm provides better positioning than goosenecks and is easier to clean*

**Table Mount Model**



**Floorstand**



**Ceiling Mount**



**Wall Mount**

*All models are sold complete with light and arm system. (Product images not to scale.)*

## Ordering Information

### SUPER EXAM LED

I 20V Model	Description
SELEDFL	Floorstand Model
SELEDC	Ceiling Mount Model
SELEDT	Table Mount Model
SELEDW	Wall Mount Model

*Note: This product is NOT available in Norway, Sweden, Finland, Denmark, Estonia, Russia, Germany, UK, Ireland, Australia, Spain, the Netherlands or Iceland.*



#### Intuitive and ergonomic

*The power and dimming switch is positioned near the handle for one-handed operation.*



#### Dimming feature

*The power button also serves as a dimming switch.*



#### SteriTouch® antimicrobial powder coating

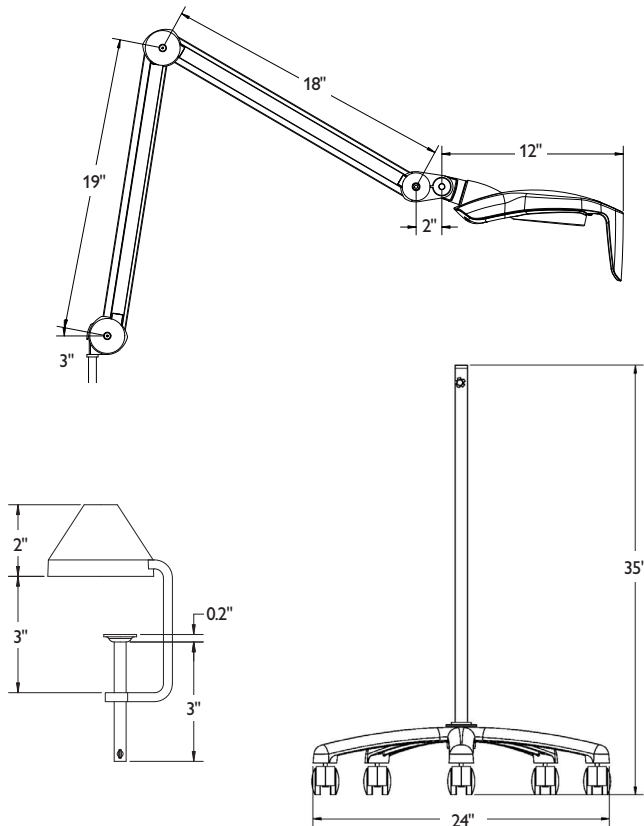
*Prevents the growth of bacteria, biofilm and mold continuously throughout the product's lifetime.*



#### Extremely energy efficient

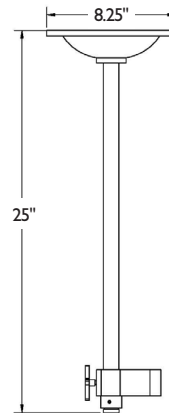
*Super Exam LED features a long lasting, energy-efficient LED light source with an incredible lifespan of 50,000 hours or more.*

# Super Exam LED product dimensions

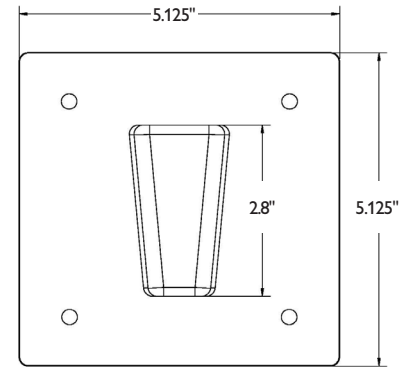


**Table Mount**

**Floorstand**



**Ceiling Mount**



**Wall Mount**

## Summary of technical data

### SUPER EXAM LED

Illuminance:	35,000 lux (3251 fc) at 39.37" (1 m) <sup>1</sup>
Color temperature:	4000 K <sup>1</sup>
CRI	>95 <sup>1</sup>
Light sources:	Light Emitting Diode, minimum 50,000-hour rated life
Power:	20 Watts
Mounting options:	Single Ceiling, Table, Floor and Wall
Applications:	General examination <sup>2</sup>
Certifications/Approvals:	ES 60601-1, IEC 60601-2-41, -1-6, EN 60601-1-2, CAN/CSA C22.2 NO. 60601-1
Product warranty:	5-year parts

Note: <sup>1</sup> The optical data are nominal values based on measurements calculated according to UL/IEC performance standards

<sup>2</sup> For 120V application only

© 2016 Koninklijke Philips N.V. All rights reserved.  
Philips reserves the right to make changes in specifications and/or to discontinue any product at any time without notice or obligation and will not be liable for any consequences resulting from the use of this publication.  
SteriTouch® is a registered trademark of SteriTouch, Ltd.



Philips Burton  
2300 W Windsor Ct., STE C  
Addison, IL 60101  
Burtonmedical.com

**PHILIPS**  
**burton**

Phone (800) 444-9909, Fax (800) 765-1770

LIT-0101 Rev 02